

96457/96458

Infrared Motion Sensor Instruction Manual



Welcome to use 96457/96458 infrared motion sensor!

The product adopts good sensitivity detector and integrated circuit. It combines automation, convenience, safety, energy-efficiency and practical functions. It utilizes the infrared energy from humans as control-signal source and it can start the load at once when one enters the detection field. It can identify day and night automatically. It is easy to install and used widely.

SPECIFICATION:

Power Source: 220-240V/AC	Detection Range: 180°
Power Frequency: 50Hz	Detection Distance: 12m max(<24C°)
Ambient Light: <3-2000LUX (adjustable)	Working Temperature: -20~+40C°
Time Delay: Min.10sec±3sec	Working Humidity: <93%RH
Max.7min±2min	Power Consumption: approx 0.5W
Rated Load: Max.1200W	Installation Height: 1.8-2.5m
300W	Detection Moving Speed: 0.6-1.5m/s

FUNCTION:

- Can identify day and night: The consumer can adjust working state in different ambient light. It can work in the daytime and at night when it is adjusted on the "sun" position (max). It can work in the ambient light less than 3LUX when it is adjusted on the "3" position (min). As for the adjustment pattern, please refer to the testing pattern.
- Time-Delay is added continually: When it receives the second induction signals within the first induction, it will restart to time from that moment.

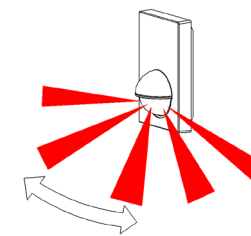

Good sensitivity

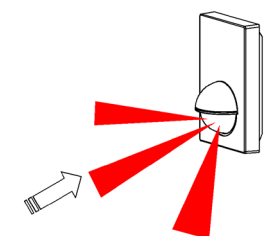
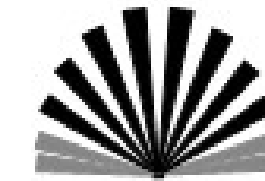

Poor sensitivity

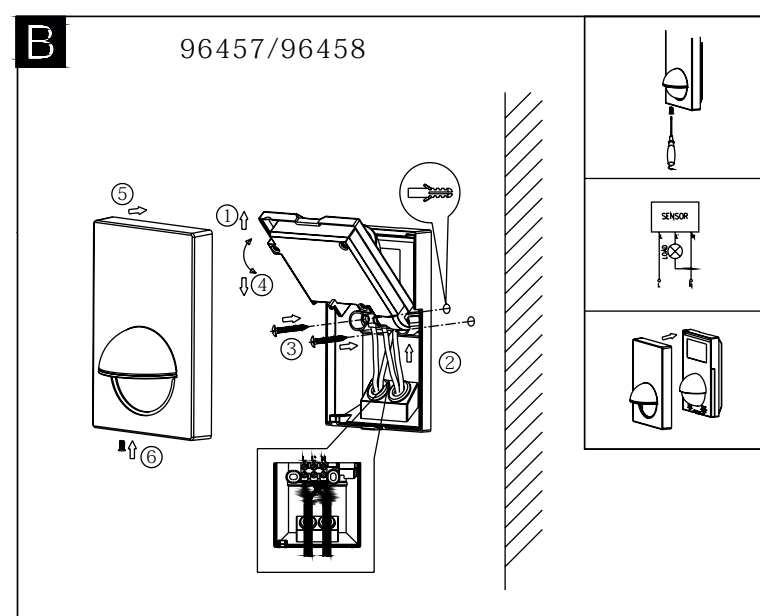
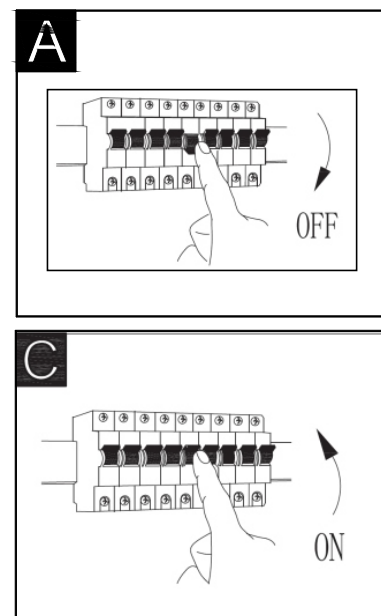

Tension	220-240V~, 50 Hz
Amplitude	Max. 1200W Max. 300W
CE	Conforme aux normes européennes en vigueur.
	Classe II
	Non compatible avec l'utilisation d'un variateur d'intensité lumineuse.
	Les produits électriques usagés ne doivent pas être jetés avec les ordures ménagères. Veuillez utiliser les aménagements spécifiques prévus pour les traiter. Renseignez-vous auprès des autorités locales ou de revendeur pour obtenir la marche à suivre en matière de recyclage.
	Pour utilisation à l'intérieur. IP44

INSTALLATION ADVICE:

Since the detector responds to changes in temperature, avoid the following situations:

- Avoid pointing the detector towards objects with highly reflective surfaces, such as mirrors etc.
- Avoid mounting the detector near heat sources, such as heating vents, air conditioning units, light etc.
- Avoid pointing the detector towards objects that may move in the wind, such as curtains, tall plants etc.

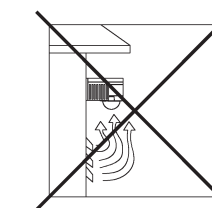
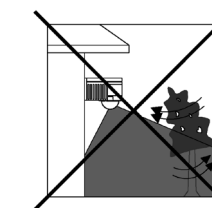
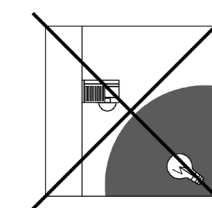
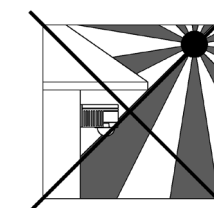

WARNING



Warning. Danger of death through electric shock!

- Must be installed by professional electrician
- Disconnect power source.
- Cover or shield any adjacent live components.
- Ensure device cannot be switched on.
- Check power supply is disconnected.

- Loosen the screw on the bottom and open the front cover. (refer to figure 1 and 2).
- Loosen the screw on the back, fold the cover and then mount it with included screw on the selected position. (refer to the figure 3)
- Plug the wire into the hole with gasket, and then connect the wire with connection column according to Connection-wire diagram. (Note: The wire and the hole gasket should connect very tightly to make the product waterproof)
- Switch on the power and then test it.

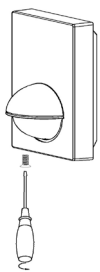

Figure 1

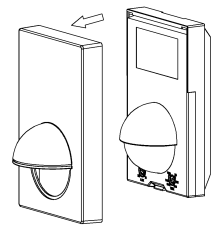

Figure 2

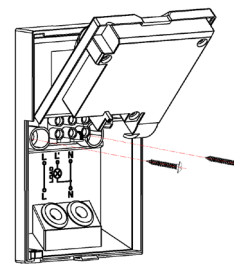
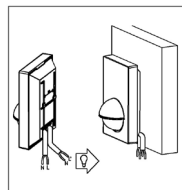
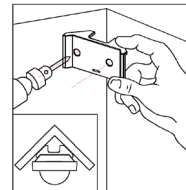

Figure 3

- It can be installed directly on the wall, and can also be installed in the inner corner with the help of the widget (refer to photo below)



Flat Mounted



Inner corner mounted

CONNECTION-WIRE DIAGRAM: (See the right figure)

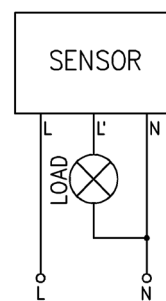

SENSOR INFORMATION:

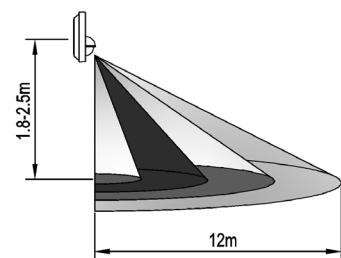

Height of installation: 1.8-2.5m

Note: you can cut the plastic sticker to whatever shape you want and make different detection range. (refer to figure below)

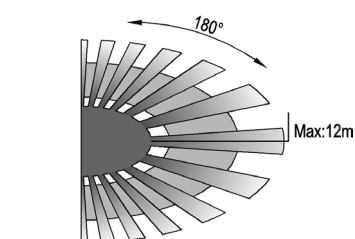
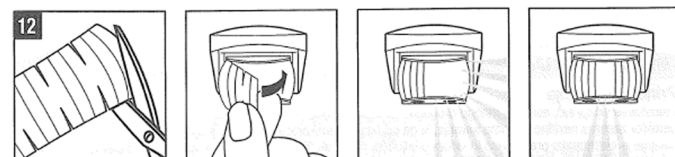

Detection Distance: Max.12m

TEST:

- Turn the LUX knob clockwise on the maximum (sun); turn the TIME knob counter-clockwise on the minimum (10s).
- Switch on the power; the sensor and its connected lamp will have no signal at the beginning. After Warm-up 30sec, the sensor will start to work. If the sensor receives the induction signal, the lamp will turn on. When there is no another induction signal any more, the load will stop working within 10sec±3sec and the lamp will turn off.
- Turn LUX knob anti-clockwise on the minimum (3). If the ambient light is more than 3LUX, the sensor will not work and the lamp will stop working too. If the ambient light is less than 3LUX (darkness), the sensor will work. Under no induction signal condition, the sensor will stop working within 10sec±3sec.

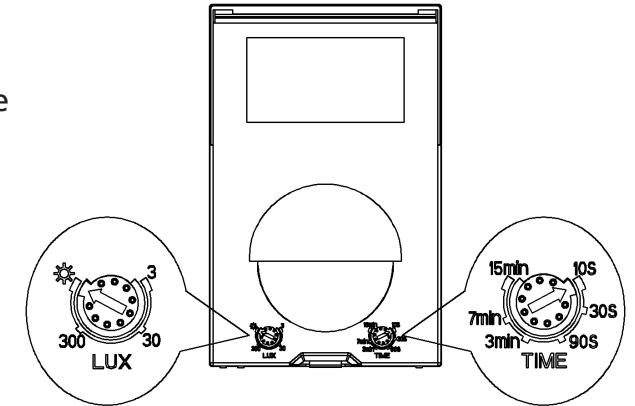

Note: when testing in daylight, please turn LUX knob to ☀ (sun) position, otherwise the sensor will not work!

SOME PROBLEMS AND SOLUTIONS:

- The load does not work:
 - a. Please check if the connection of power source and load is correct.
 - b. Please check if the load is good.
 - c. Please check if the settings of working light correspond to ambient light.
- The sensitivity is poor:
 - a. Please check if there is any hindrance in front of the detector to affect it to receive the signals.
 - b. Please check if the ambient temperature is too high.
 - c. Please check if the induction signal source is in the detection field.
 - d. Please check if the installation height corresponds to the height required in the instruction.
 - e. Please check if the moving orientation is correct.
- The sensor can not shut off the load automatically:
 - a. Please check if there is continual signal in the detection field.
 - b. Please check if the time delay is set to the maximum position.
 - c. Please check if the power corresponds to the instructions.

EU - EGLO Leuchten GmbH, Heiligkreuz 22, 6136 Pill, Austria
BA- EGLO Rasvjeta BH D.O.O., Ormanica bb, BIH-76250 Gradacac, Tel.+387 35 86 85 00, Fax +387 35 82 44 41 BG-EGLO Bulgaria EOOD 2B 'Serdika' Str., 8000 Bourgas, Tel. +359 56 960 401, Fax +35956 530 595
CZ- EGLO Cesko-Moravská Svítidla, SPOL. S.R.O., Náchodská 2479/63, CZ-193 00 Praha 9 Horní Pocernice, Tel. +420 281 924 163x +420 281 925 205
HU- EGLO LUX KFT.- Sale, FŐ-ÚT 143/A, H-2120 Dunakeszi, Tel. +36 27 341 353, Fax +36 27 341 409
KS-EGLO Kosovo LLC, Lugisht e qytetit pn, 20000 Prizren - Kosovo, Tel: +337 44 2166 87
HR-EGLO Rasvjeta D.O.O., Josipa Loncara 3, HR-10000 Zagreb, Tel. +385 1 37940 62, Fax +385 1 379 41 04
RO- EGLO Romania Prodexim SRL, Str. Atomistilor Nr. 1D, R-077125 Magurele-Ilvov-Romania, Tel. +40 314 250 897, Fax +314 250 899
RU -ООО ЭГЛО Лайтинг, ул. Промышленная, д. 11, строение 3, офис419, Россия-115516 Москва, Tel. +7495 789 4311, Fax +7495 789 4312
RS-EGLO Rasveta D.O.O Beograd, Stefana Prvovenanog 28, 11000 Beograd, Srbija, Tel. +381 11 3981 366, Fax +381 11 3095 136
TR- EGLO Aydinlatma thalat hracat LTD, Eyüp Sultan Mah. Sekmen Cad. No: 18/1,34855 Samandira, Sancaktepe/ stanbul, Tel. +90 216 311 09-02/-03/-04, Fax +90 216 311 09-05
UA-EGLO Ukraine LTD, Str. Marko Vovchka 14, UA-04073 Kiev, Tel. +38 44 463 98 41, Fax +38 44 468 84 67

Made in China